

Hybrid Stepping Motor

TYPE: KL42H150-42-8B

COMMON RATINGS

Step angle: 1.8	Dielectric strength: 500VDC
Positional accuracy: +/-5%	Insulation resistance: 100MOhm(500VDC)
Number of Phase: 4	Radial play: 0.025mm max. (load 450g)
Temperature rise: 80% Max	Insulating class: B
Inertia: $1.1 \times 10^3 \text{ kg.m}^2$	Weight: 9.0kg

SPECIFICATIONS

	Holding Torque (2 phases on) N.m	Rated Current/Phase (Amps DC)	Phase Resistance (ohms)	Phase Inductance (mH) 70% Typical
Bipolar(Parallel)	20	6.0	1.4	26
Bipolar(Series)	20	3.0	5.4	104
Unipoar	14	4.2	2.7	26

DIMENSIONS unit=mm

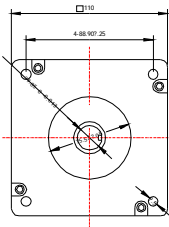
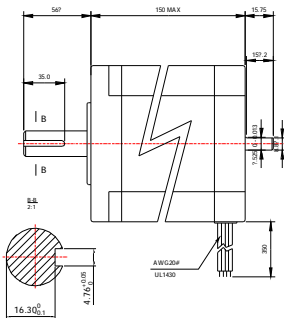

CONNECTIONS

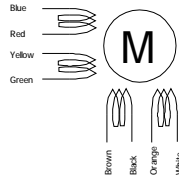

Bipolar (Parallel) Connection	Bipolar (Series) Connection	Unipolar Connection
<p>Blue A+ Red A- Yellow B+ Green B-</p> <p>Brown Black Orange White</p>	<p>Blue A+ Red A- Yellow B+ Green B-</p> <p>B- B+ Brown Black Orange White</p>	<p>Blue A+ Red A- Yellow B+ Green B-</p> <p>B- B+ Brown Black Orange White</p>