

Hybrid Stepper Motor

KL34H280-45-8B

UNIT=MM:

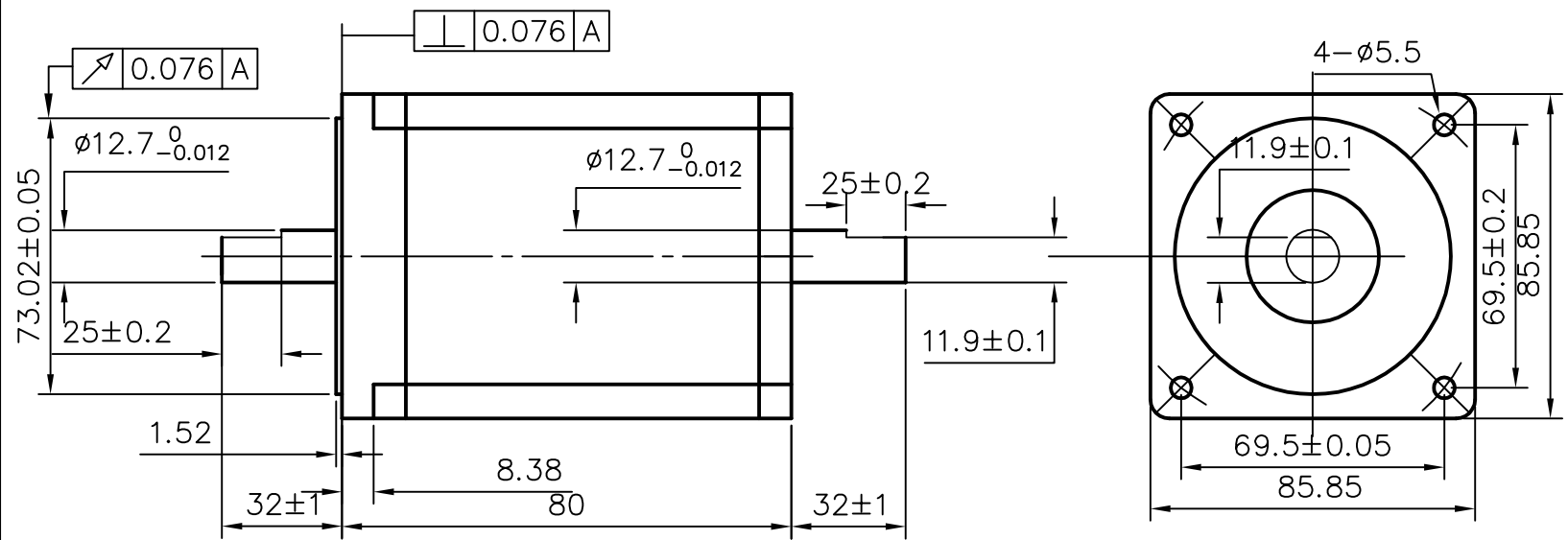

STEP ANGLE	CONNECTION STYLE	CURRENT	RESISTANCE	INDUCTANCE	HOLDING TORQUE	ROTOR INERTIA	WEIGHT
DEG/STEP		A	ohms	mH	OZ-IN	gcm ²	Kg
1.8	Parallel	6.4	0.36	2.2	640	1400	2.3
	Series	3.2	1.42	8.8			
	Unipolar	4.5	0.71	2.2	465		

