

specifications:

PHASE	STEP ANGLE	RATED VOLTAGE	CURRENT /PHASE	RESISTANCE /PHASE	INDUCTANCE /PHASE	HOLDING TORQUE	ROTOR INERTIA	WEIGHT
	DEG/STEP	V	A	ohms	mH	N.cm	gcm ²	Kg
4	1.8	4.32	2.4	1.8	3.3	80	275	0.65

Wiring Diagram:

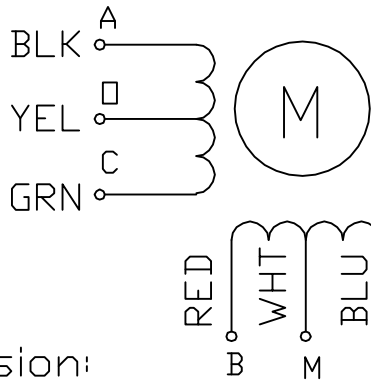

CW DIRECTION	STEP	A	C	B	D	O	M
↓	1	+		+		+	+
	2		+	+		+	+
	3		+		+	+	+
	4	+			+	+	+
	1	+		+		+	+

SEE FROM THE SHAFT END

Dimension:

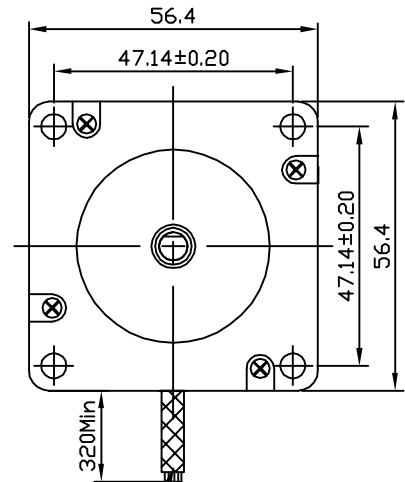
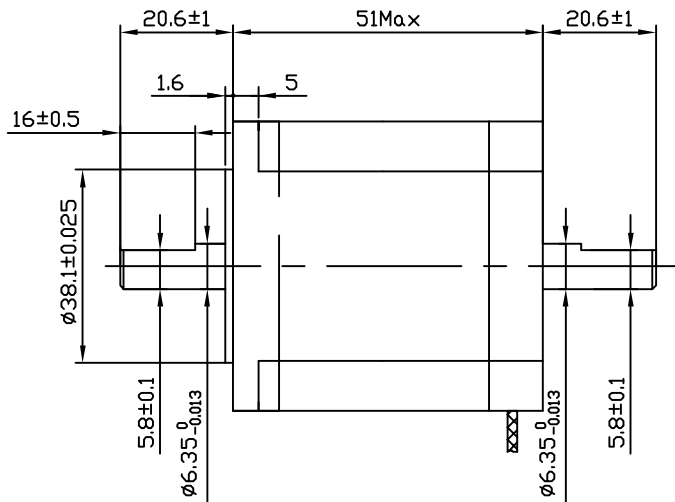

Note: black end cap

UL 1007 AWG22

DESIGN	DATE	P/N.
CHECK		TITLE ² SPECIFICATION
APPD		USED ON ² KL23H251-24-6B
SCALE		DWG NO. FX3.162. JS
SHEET OF		REV
Keling Technology, Inc		

REV	ECN NO.	DESCRIPTION	DRN	APP'D	DATE
UNLESS OTHERWISE SPECIFIED TOLERANCES: DECIMALS: .x ±0.5 .xx ±0.25 .xxx ±0.1 UNIT: mm DO NOT SCALE DRAWING					
MATERIAL					
THIRD ANGLE PROJECTION					