

# 2-Phase Stepping Motors

Standard Type

85.85mm

Step Angle 1.8°

## Specifications

Model Single Shaft Double Shaft	Connection Type	Holding Torque ± 10% N.m	Current per Phase A/phase	Voltage V DC	Resistance per Phase ± 10% Ω/phase	Inductance (1KHz) ± 20% mH/phase	Rotor Inertia J kg.m <sup>2</sup>	Lead Wires (Pin)	Connection Diagram
34H260-01A(B)	Bipolar	2.8	6.0	1.8	0.3	1.6	1.0X10 <sup>-4</sup>	4	1
34H260-02A(B)	Bipolar	2.8	3.0	3.6	1.2	6.4		4	1
34H260-03EA 34H260-03EB	Bipolar(parallel)	2.8	4.2	2.4	0.57	3.13		8	3(A)
	Bipolar(Series)	2.8	2.1	4.8	2.28	12.5			3(B)
	Unipolar	2.0	3.0	3.4	1.14	3.13			3(C)
34H280-01A(B)	Bipolar	4.2	6.0	2.4	0.4	3.4		1.6X10 <sup>-4</sup>	4
34H280-02A(B)	Bipolar	4.2	3.0	4.8	1.6	13.6	4		1
34H280-03EA 34H280-03EB	Bipolar(parallel)	4.2	4.2	3.2	0.76	6.66	8		3(A)
	Bipolar(Series)	4.2	2.1	6.4	3.04	26.6			3(B)
	Unipolar	3.0	3.0	4.6	1.52	6.66			3(C)
34H2120-01A(B)	Bipolar	8.2	6.0	3.3	0.55	6.2	3.2X10 <sup>-4</sup>		4
34H2120-02A(B)	Bipolar	8.2	3.0	6.6	2.2	24.8		4	1
34H2120-03EA 34H2120-03EB	Bipolar(parallel)	8.2	4.2	4.4	1.04	12.2		8	3(A)
	Bipolar(Series)	8.2	2.1	8.8	4.16	48.8			3(B)
	Unipolar	5.8	3.0	6.2	2.08	12.2			3(C)

# 2-Phase Stepping Motors

## General Specifications

Item	Specifications
Shaft Runout	0.05(mm)
Perpendicularity	0.075(mm)
Concentricity	Ø0.075(mm)
Shaft Radial Paly	0.025Max of 5N
Shaft Axial Paly	0.075 mm Max of 10N
Step Angle	1.8°
Positional Accuracy	± 5%
Insulation Resistance	100 MΩ DC 500V 25° C
Dielectric Strength	DC500V 1minute
Insulation Class	Class B 130° C
Temperature Rise	80° C
Operating Temperature	-10° C~+40° C

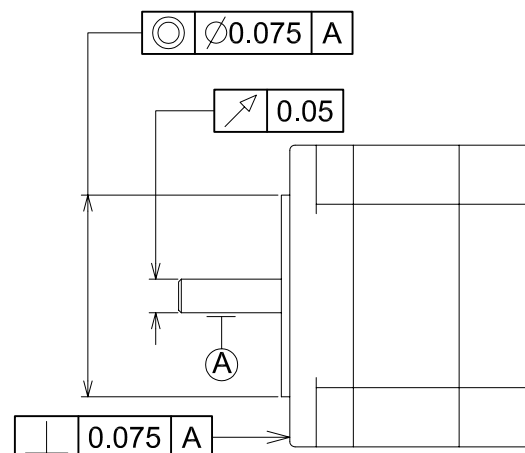

## Wirings and Connections

### Motor Wirings

4 Leads Motor	6 Leads Motor	8 Leads Motor
1	2	3

### Wirings Connection Diagram

8 Leads Bipolar (Parallel) Connection	8 Leads Bipolar (Series) Connection	8 Leads Unipolar Connection
A	B	C

## 2-Phase Stepping Motors

### Standard Type

 85.85mm

Step Angle 1.8°

Dimensions unit: mm

34H260-01A;34H260-02A;34H260-03EA(Single Shaft) Mass 1.7kg  
34H260-01B;34H260-02B;34H260-03EB(Double Shaft) Mass 1.7kg

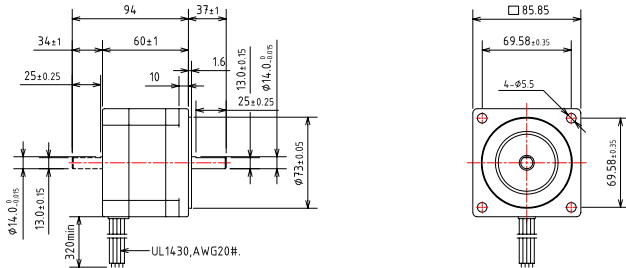

34H280-01A;34H280-02A;34H280-03EA(Single Shaft) Mass 2.4kg  
34H280-01B;34H280-02B;34H280-03EB(Double Shaft) Mass 2.4kg

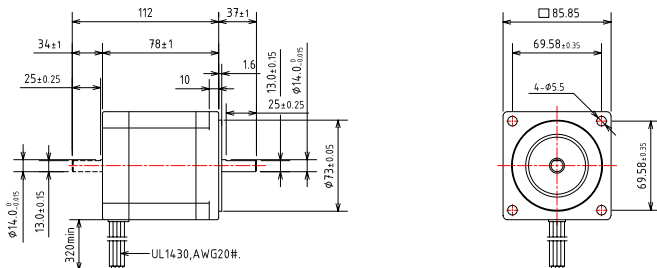

34H2120-01A;34H2120-02A;34H2120-03EA(Single Shaft) Mass 3.8kg  
34H2120-01B;34H2120-02B;34H52120-03EB(Double Shaft) Mass 3.8kg

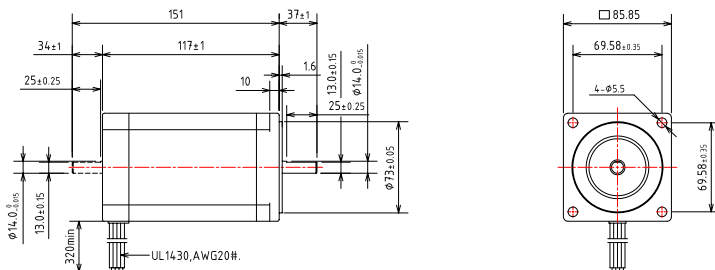

# 2-Phase Stepping Motors

## Speed-Torque Characteristic

34H260-01A Bipolar 6.0A/Phase

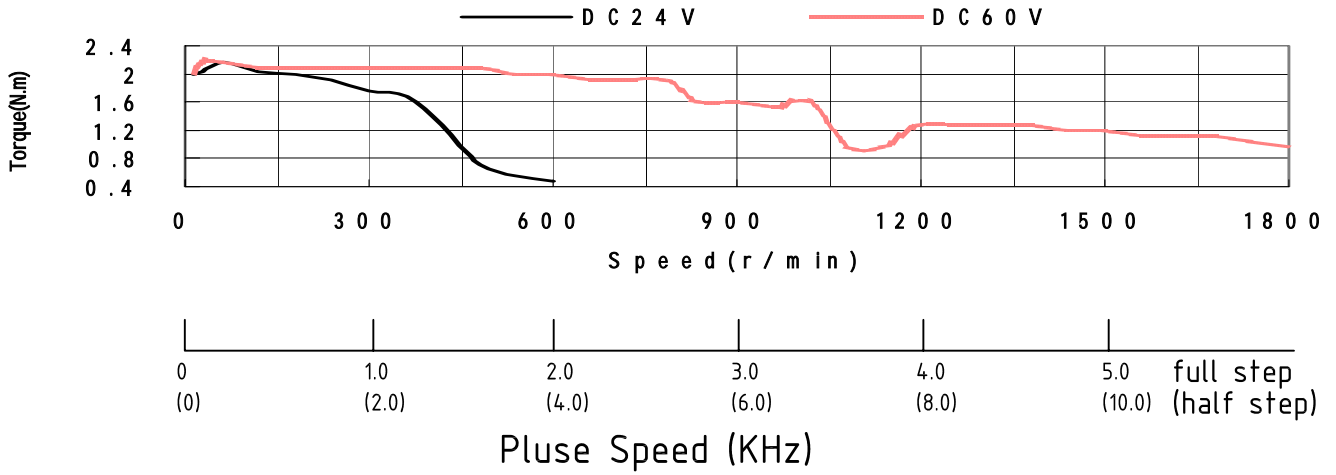

34H280-01A Bipolar 6.0A/Phase

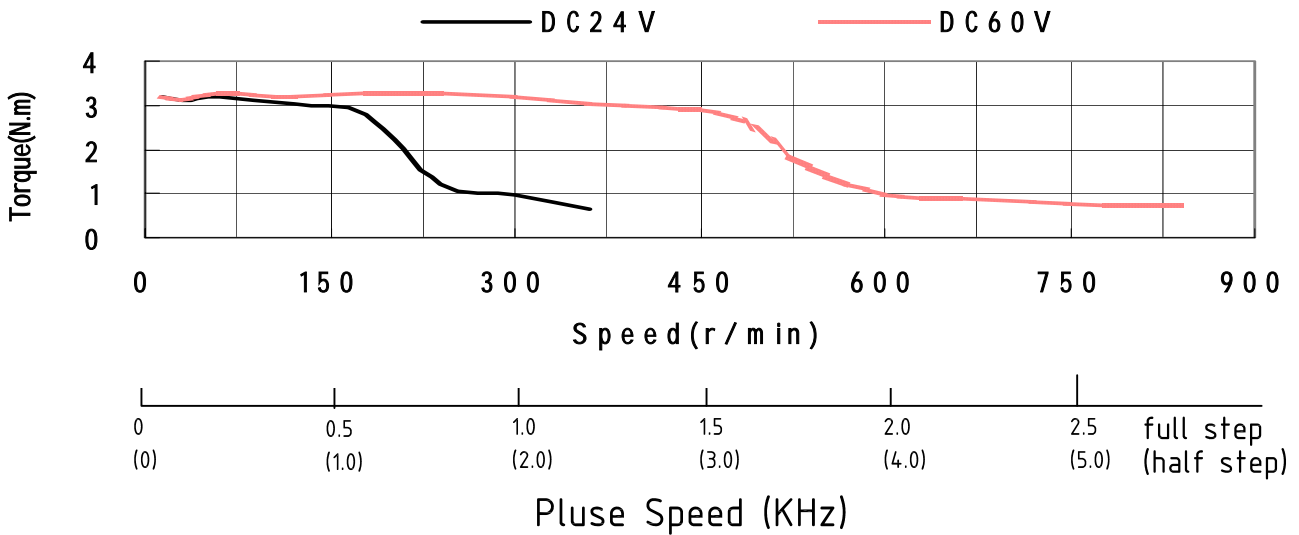

34H2120-01A Bipolar 6.0A/Phase

