

2-Phase Stepping Motors

Standard Type

□ 57.15mm

Step Angle 1.8°

Specifications

Model Single Shaft Double Shaft	Connection Type	Holding Torque ± 10% N.m	Current per Phase A/phase	Voltage V DC	Resistance per Phase ± 10% Ω/phase		Inductance (1KHz) ± 20% mH/phase	Rotor Inertia J kg.m ²	Lead Wires (Pin)	Connection Diagram
23H246-01EA 23H246-01EB	Bipolar(parallel)	0.64	3.0	1.3	0.43	1.09	1.2X10 ⁻⁵	8	A	
	Bipolar(Series)	0.64	1.5	2.6	1.72	4.36			B	
	Unipolar	0.45	2.12	1.8	0.86	1.09			C	
23H255-01EA 23H255-01EB	Bipolar(parallel)	1.0	3.0	1.6	0.54	1.98	2.0X10 ⁻⁵	8	A	
	Bipolar(Series)	1.0	1.5	3.2	2.14	7.92			B	
	Unipolar	0.7	2.12	2.26	1.07	1.98			C	
23H262-01EA 23H262-01EB	Bipolar(parallel)	1.28	3.0	1.86	0.62	2.1	3.0X10 ⁻⁵	8	A	
	Bipolar(Series)	1.28	1.5	3.72	1.46	8.4			B	
	Unipolar	0.9	2.12	2.6	1.23	2.1			C	
23H280-01EA 23H280-01EB	Bipolar(parallel)	2.0	3.0	2.46	0.82	3.8	4.8X10 ⁻⁵	8	A	
	Bipolar(Series)	2.0	1.5	4.92	3.26	15.2			B	
	Unipolar	1.35	2.12	3.45	1.63	3.8			C	

2-Phase Stepping Motors

General Specifications

Item	Specifications
Shaft Runout	0.05(mm)
Perpendicularity	0.075(mm)
Concentricity	Ø0.075(mm)
Shaft Radial Paly	0.025Max of 5N
Shaft Axial Paly	0.075 mm Max of 10N
Step Angle	1.8°
Positional Accuracy	± 5%
Insulation Resistance	100 MΩ DC 500V 25° C
Dielectric Strength	DC500V 1minute
Insulation Class	Class B 130° C
Temperature Rise	80° C
Operating Temperature	-10° C~+40° C

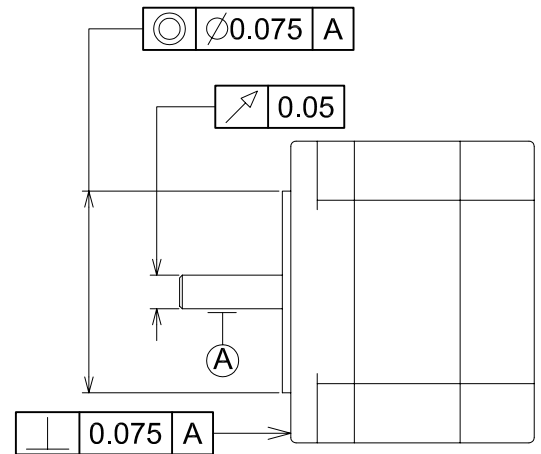

Wirings and Connections

Motor Wirings

4 Leads Motor	6 Leads Motor	8 Leads Motor
1	2	3

Wirings Connection Diagram

8 Leads Bipolar (Parallel) Connection	8 Leads Bipolar (Series) Connection	8 Leads Unipolar Connection
A	B	C

2-Phase Stepping Motors

Dimensions unit: mm

23H246-0--A,23H246-01EA(Single Shaft) Mass 0.5kg
23H246-0--B,23H246-01EB(Double Shaft) Mass 0.5kg

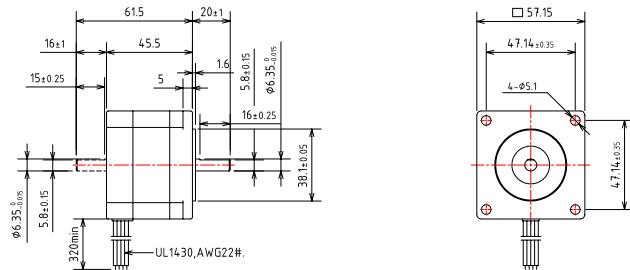

23H255-0--A,23H255-01EA(Single Shaft) Mass 0.7kg
23H255-0--B,23H255-01EB(Double Shaft) Mass 0.7kg

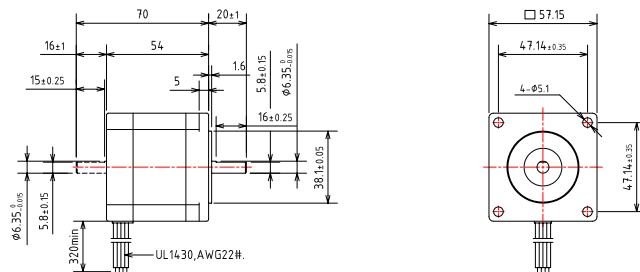

23H262-0--A,23H263-01EA(Single Shaft) Mass 0.85kg
23H262-0--B,23H262-01EB(Double Shaft) Mass 0.85kg

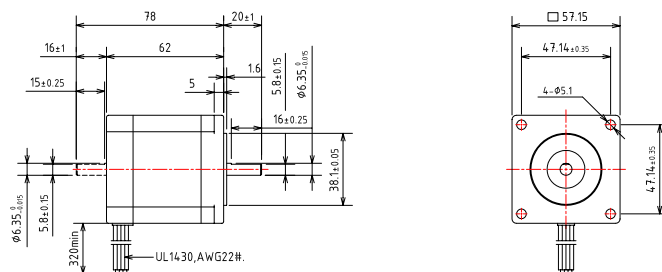

23H280-0--A,23H280-01EA(Single Shaft) Mass 1.15kg
23H280-0--B,23H280-01EB(Double Shaft) Mass 1.15kg

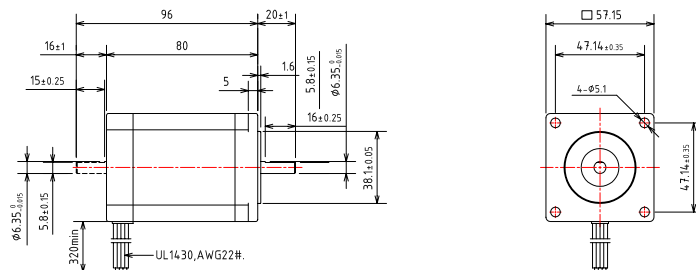

2-Phase Stepping Motors

Speed-Torque Characteristic

● 23H246-01EA Bipolar(Seriell) 1.5A/Phase

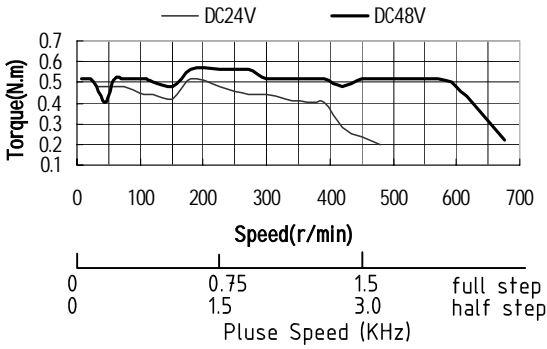

● 23H246-01EA Bipolar(parallel) 3.0A/Phase

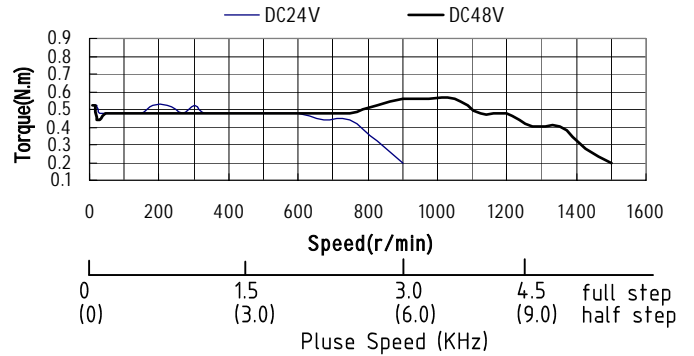

● 23H255-01EA Bipolar(seriell) 1.5A/Phase

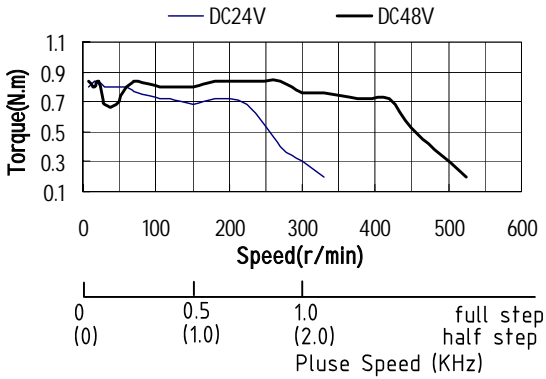

● 23H255-01EA Bipolar(Parallel) 3.0A/Phase

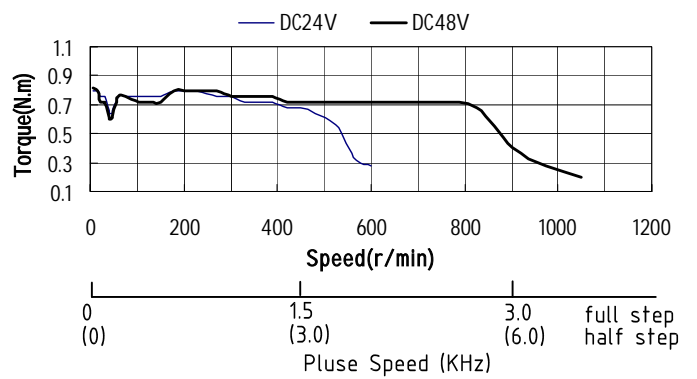

● 23H262-01EA Bipolar(Seriell) 1.5A/Phase

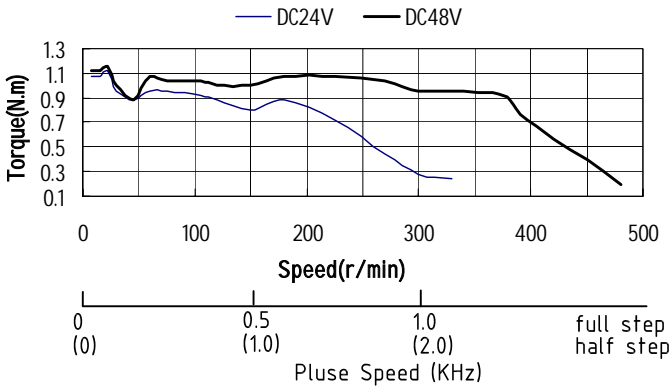

● 23H262-01EA Bipolar(Parallel) 3.0A/Phase

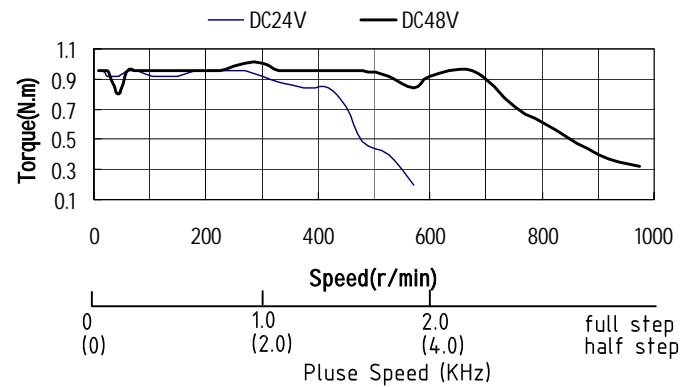

● 23H280-01EA Bipolar(Seriell) 1.5A/Phase

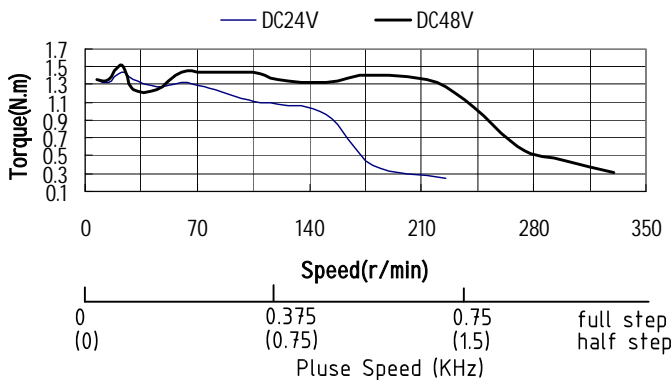

● 23H280-01EA Bipolar(Parallel) 3.0A/Phase

