

GDF60-18Z/4.5 220V Outline diagram

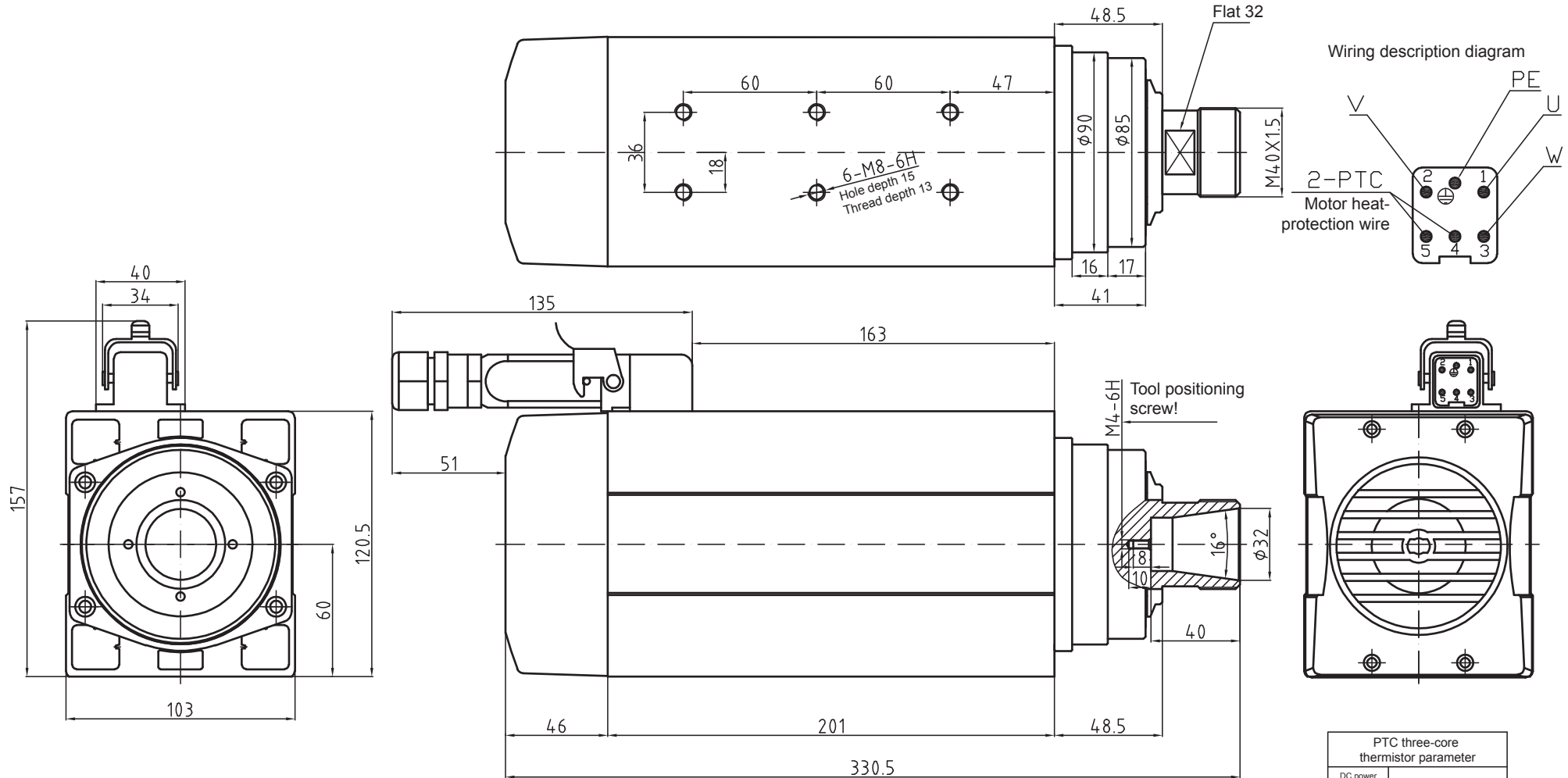

GDF60-18Z/4.5

| | | |
|----------------|-------------|--|
| Power | 4.5 kw | Weight: 12KG |
| Voltage | 220 V | ER nut: ER32 |
| Current | 15.0 A | Cooling method: air cooling |
| Frequency | 300 Hz | Bearing lubrication method: grease lubrication |
| Rotating speed | 18000 r/min | High-precision angular contact ball bearing: 2×7008C P4/2×7002C P4 |

Rotating direction: anticlockwise from the shaft extension end

Special attention: thread locking adhesive shall be applied or the spring washer shall be added to prevent the looseness during the installation of the fastening screw!

| PTC three-core thermistor parameter | |
|-------------------------------------|-----------------------------|
| DC power supply | Maximum DC25V/100mA |
| -20~25℃ | ≤300Ω |
| ≤90℃ | ≤750Ω |
| 105℃ | ≤1650Ω |
| 110℃ | Rated operating temperature |
| 115℃ | ≥3990Ω |
| ≥125℃ | ≥12KΩ |
| ≤160℃ | Maximum storage temperature |