

Wiring Diagram

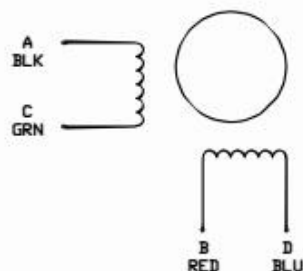

SPECIFICATIONS

1	Number of Phase	2
2	Step Angle	$0.9^\circ \pm 5\%$
3	Holding Torque	4.6 kg.cm
4	Voltage	2.2VDC
5	Current	2.0A
6	Phase Resistance (20°C)	$1.1 \pm 10\% \Omega$
7	Phase Inductance (1KHz)	$3 \pm 20\% \text{mH}$
8	Rotor Inertia	$76 \text{ g} \cdot \text{cm}^2$
9	Insulation Resistance	$100 \text{M} \Omega$ 500VDC
10	Insulation Class	B (130°C)
11	Ambient Temperature	-20°C to 50°C
12	Ambient Humidity	15% to 95%
13	Motor Weight	Approx xx kg
14		

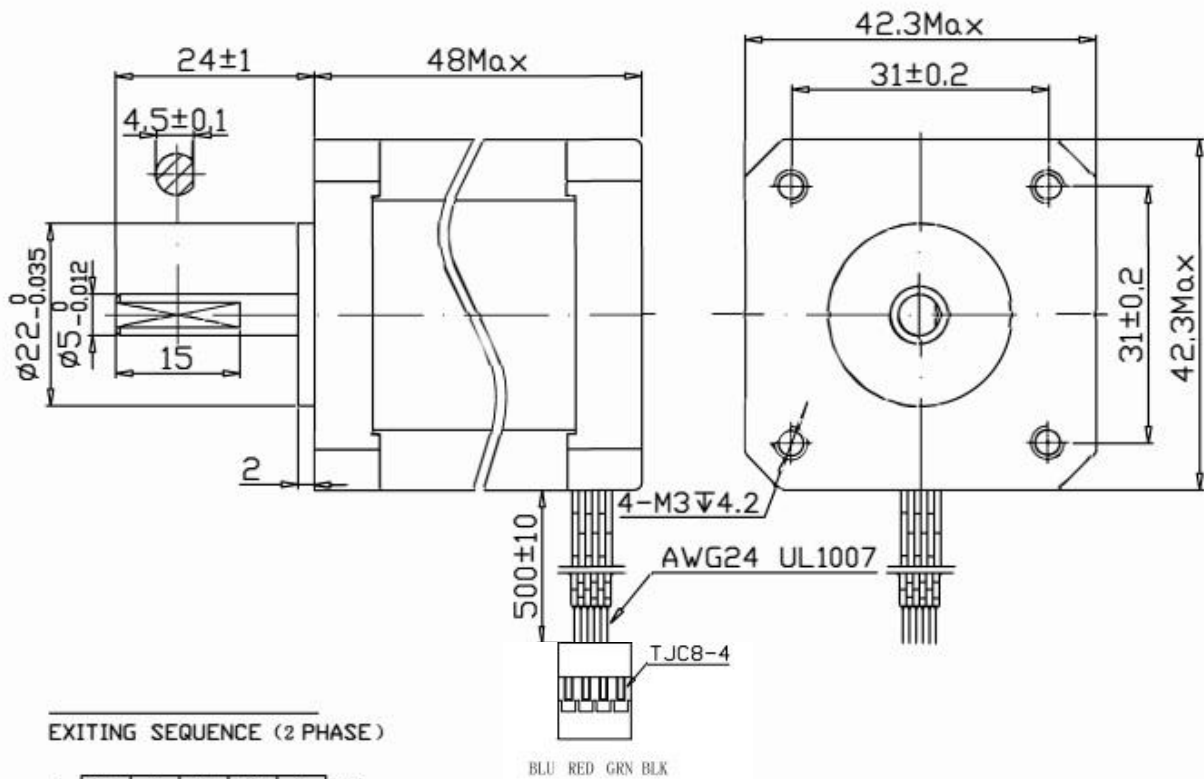

EXITING SEQUENCE (2 PHASE)

STEP	A	B	\bar{A}	\bar{B}	
1	+	+	-	-	CCW ↑
2	-	+	+	-	
3	-	-	+	+	
4	+	-	-	+	

CW ↓

Unit:mm
 第一角画法
 First angle method
 未注线性与角度尺寸公差
 Tolerances for linear and angular dimensions
 without individual tolerance indications
 GB/T 1804-m eqv ISO 2768-1:m
 未注形状与位置尺寸公差
 Geometrical tolerances for features without
 individual tolerance indications
 GB/T 1184-k eqv ISO 2768-2:k

DESIGN
 CHECK
 TECHNOLOGY
 STANDARD
 APPROVE

TYPE: HYBRID STEPPING MOTOR SCALE XX Rev. 1.0 SHEET 1 OF 6

Model: KL17H248-20-4A

REV. REVISION RECORD

DATE UNLESS OTHERWISE SPECIFIDE

NAMES SINGATURE DATE