

XXXXXX

Wiring Diagram

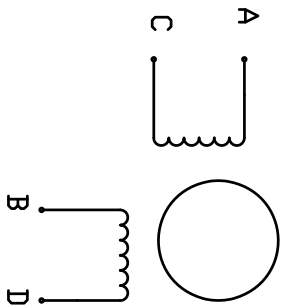

SPECIFICATIONS

| | | |
|----|-------------------------|------------------------|
| 1 | Number of Phase | 2 |
| 2 | Step Angle | 1.8° ± 5% |
| 3 | Holding Torque | 140 OZ-IN |
| 4 | Voltage | 2.32 VDC |
| 5 | Current | 2.8 A |
| 6 | Phase Resistance (20°C) | 0.83 ± 10% Ω |
| 7 | Phase Inductance (1kHz) | 2.2 ± 20% mH |
| 8 | Rotor Inertia | 230g • cm ² |
| 9 | Insulation Resistance | 100M Ω 500VDC |
| 10 | Insulation Class | B (130°C) |
| 11 | Ambient Temperature | -20°C to 50°C |
| 12 | Ambient Humidity | 15% to 95% |
| 13 | Motor Weight | Approx 0.65kg |
| 14 | | |

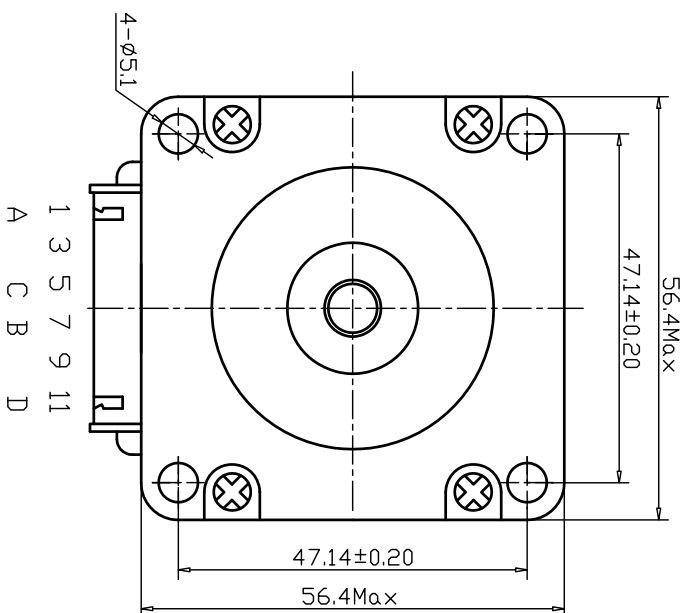
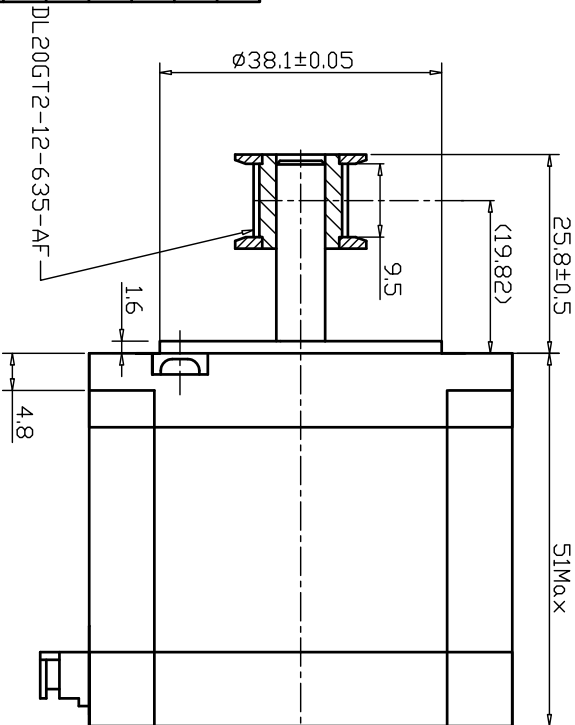

Unit:mm
 第一角画法
 First angle method
 未注线性与角度尺寸公差
 Tolerances for linear and angular dimensions
 without individual tolerance indications
 GB/T 1804-m eqv ISO 2768-1-m
 未注形位与位置尺寸公差
 Geometrical tolerances for features without
 individual tolerance indications
 GB/T 1184-k eqv ISO 2768-2:k

| | |
|------------|----------|
| DESIGN | 20151111 |
| CHECK | |
| TECHNOLOGY | |
| STANDARD | |
| APPROVE | |

STEPPING MOTOR

Model: KL23H251-28-4AP

| | | | | | | | | |
|-----------------------------|----------|---|---|---|---|---|---|---|
| REV | A | B | C | D | E | F | G | H |
| DATE | 20151111 | | | | | | | |
| UNLESS OTHERWISE SPECIFIED | | | | | | | | |
| NAMES | | | | | | | | |
| SIGNATURE | | | | | | | | |
| DATE | | | | | | | | |
| TYPE: HYBRID STEPPING MOTOR | | | | | | | | |
| SCALE XX | | | | | | | | |
| Rev. 1.0 | | | | | | | | |
| SHEET 1 OF 1 | | | | | | | | |